

Interval WIFI Footswitch for X-Air Mixer Quick Start

This footswitch controls a Behringer digital mixer XAIR series over WIFI.

<http://footswitch.groupe-interval.fr>

Each footswitch belong to a band member who manage his mix on his monitor and his channel to the front scene.

Specifications

- Control 5 channels, 4 FX (mute/sends/delay), 1 monitor and the WAV AUX player
- Wireless with 6 hours battery autonomy USB rechargeable
- Auto-reconnect WIFI and console in case of interruption
- Small footprint (multiple functions per button and small OLED screen)
- Setup via web app. with manual or automatic Firmware update

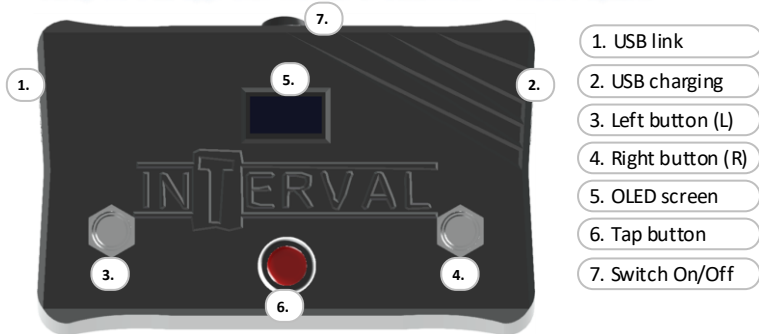

At first startup, your footswitch is not connected to any WIFI and it will act as an Access Point. This you to connect your laptop or mobile (which is the client) to it and perform initial configuration via a web application at <http://192.168.1.4> or <http://myfoot.local> by default



Once footswitch WIFI is connected directly to your mixer or via a router (they act as an Access point) it will automatically discover and connect your mixer (unless you force an IP address in the web config application).

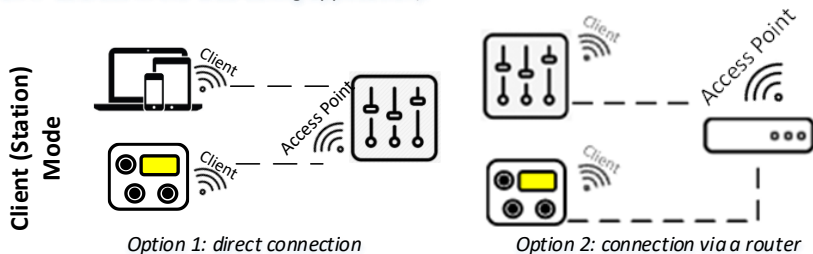

In both mode - Client(station) Mode or AP Mode - you can connect any time the web application to configure the footswitch.

Three temporary switches performs different action, depending how long they are pressed and the operating mode :

- "Tap" button (middle): trigger an action, switch between screens or switch screen layout
- "L" and "R" button: used to toggle, increase/decrease/go up or down or select an item

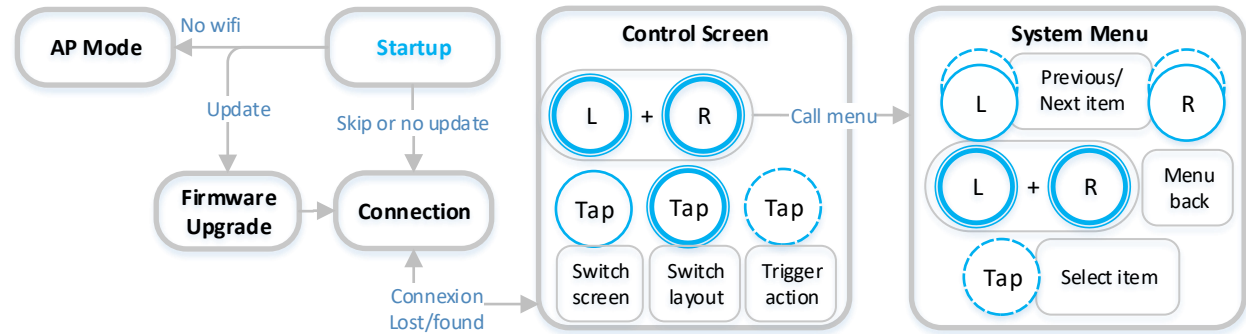
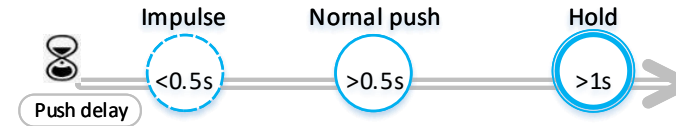

AP Mode

No WIFI "WIFInamer"
Plug in power and open SSID: **myfoot**
Waiting....

Connection

Searching

The footswitch is trying to connect WIFI and/or the mixer. Change configuration via web application if necessary.

System Menu

menu item1
menu item2
menu item3
menu item4

▶ Info:
▶ **WIFI setting**
└ Access Point : enter Access Point mode
└ Station mode: connect your WIFI
▶ **Firmware**
└ Upgrade: get the latest update from the web
└ Reset: reset to factory default settings
└ Restart: restart the footswitch

▶ **Firmware Upgrade**
V1.01->New
Flashing do not stop!

Be aware that:
- process will not start if battery is low (icon blinking)
- **NEVER INTERRUPT** flashing process by switching off the footswitch or other manipulation

Control Screen

FX1 FX2 FX3 FX4

information screen

Control screen (details next page) provides functions to control the mixer. Navigate within the user-define screen by pressing the Tap button. Hold Tap to switch the layout from an overall mixer-fader to single screen. L/R button define which ch/fx/bus to control. Blinking chan/fx/Bus are muted.

▶ **Info:**

▶ **WIFI setting**

└ Access Point : enter Access Point mode

└ Station mode: connect your WIFI

▶ **Firmware**

└ Upgrade: get the latest update from the web

└ Reset: reset to factory default settings

└ Restart: restart the footswitch

▶ **Firmware Upgrade**

V1.01->New

Flashing do not stop!

Be aware that:

- process will not start if battery is low (icon blinking)

- **NEVER INTERRUPT** flashing process by switching off the footswitch or other manipulation

▶ **WIFI signal strength.** Blinking if connection lost

▶ **Battery level.** Blinking when you have only 10min.left

Control Screens

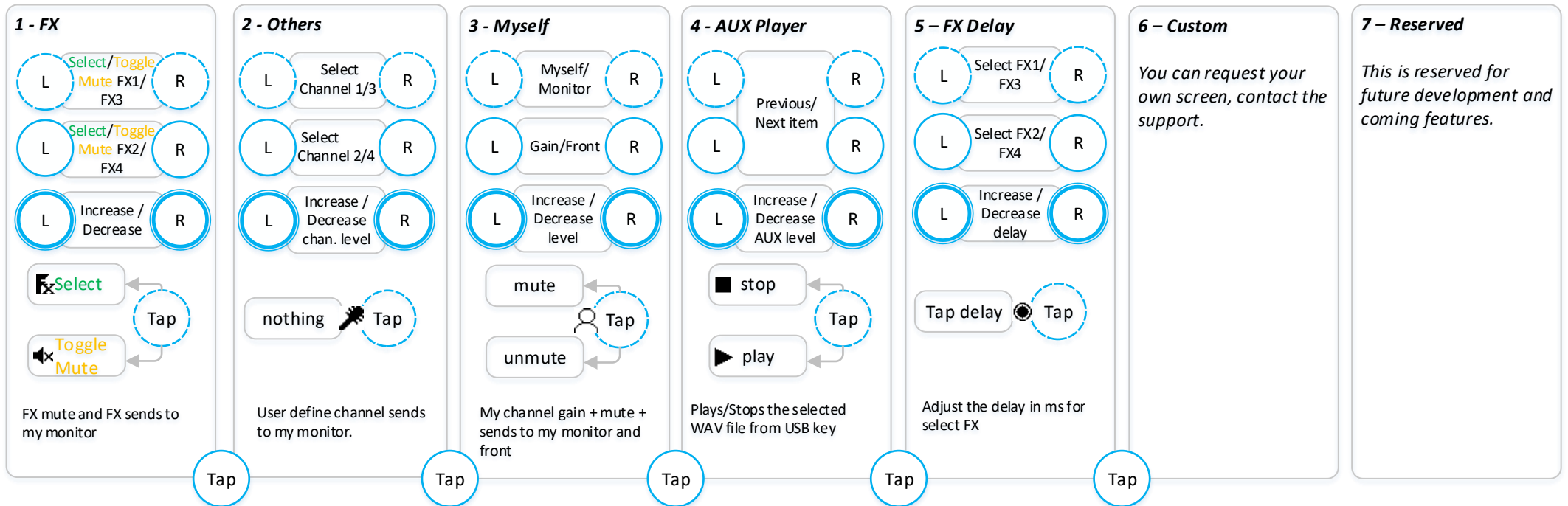

Interval WIFI Footswitch for X-Air Mixer Web Application

The foot switch is fully configurable via web application. You can reach the web application via the address IP shown in the Info Screen. If the footswitch is in configuration mode (Access Point), once you connect its SSID use <http://192.168.1.4> or using <http://apname.local>

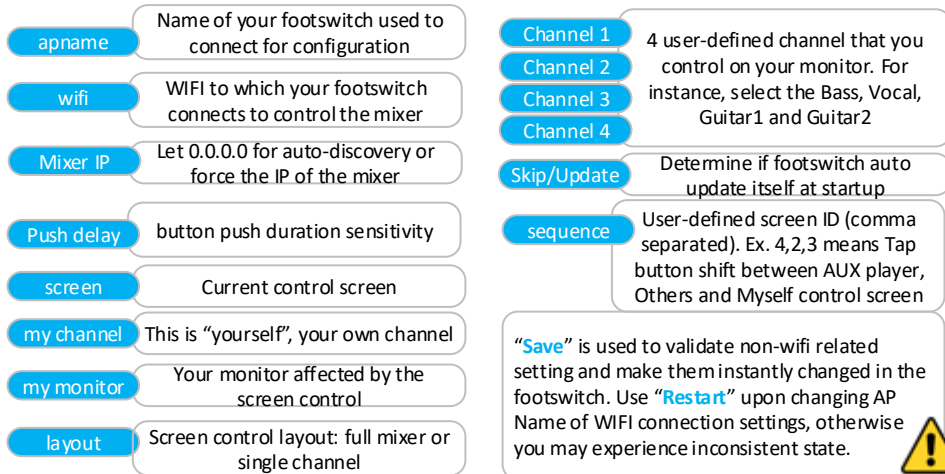

Support

Manual-update: if auto update is disabled, you can perform update manually as following:

1. Download the latest firmware from <http://footswitch.groupe-interval.fr/firmware> and save the file locally to your computer. Filename extension is .bin (ex. "1.01.ino.d1.mini.bin").
2. Ensure both your computer and footswitch are Wifi connected and open footswitch browser (unless you change footswitch name it will be <http://myfoot.local>)
3. Clic "Go to Firmware" link at the bottom of the page
4. Select the file that you have downloaded previously and clic "Update"
5. Wait the progress bar to finish uploading the firmware to the footswitch. After a few seconds, the footswitch restart automatically. Do not shutdown or restart manually, wait the footswitch to restart.

To reach out support:

Connect <http://support.groupe-interval> and open a ticket. Always ensure you have the latest firmware installed before contacting support. In order to ease the investigation, please provide the MAC Address when prompted in the ticket form. The MAC address can be found on the "Info Screen" item from the Configuration Screen